

ASSEMBLY INSTRUCTION

BASE CABINET

MODEL#

B12 B15 B18 B21

Estimated Assembly Time: 30 - 40 minutes
2-person assembly recommended

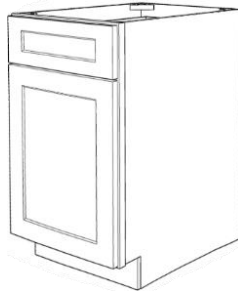

TOOLS REQUIRED

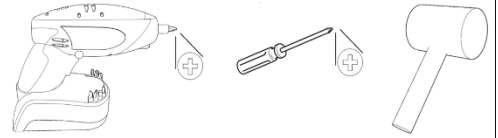

PART	DESCRIPTION	QTY	PART	DESCRIPTION	QTY
A1	Box side panel - left	1	G1	Drawer side panel - left	1
A2	Box side panel - right	1	G2	Drawer side panel - right	1
B	Box bottom panel	1	H	Drawer bottom panel	1
C	Box back panel	1	I	Drawer back panel	1
D	Face frame	1	J	Door panel	1
E	Toe kick panel	1	K	Adjustable shelf	1
F	Drawer face panel	1			

HARDWARE CONTENTS

AA Glide and runner profile x 2



Included:
5/8" Flat Head Phillips
Screw x 10



*Two additional pieces are included as an extra

BB Counter corner block x 2

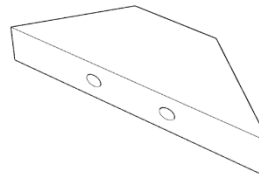

Included:
5/8" Flat Head Phillips
Screw x 8

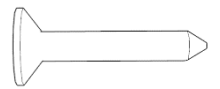

CC Adjustable drawer clips x 2

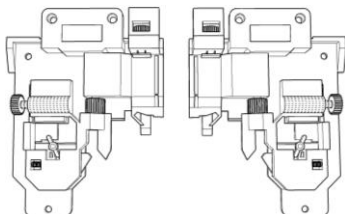

Included:
5/8" Flat Head Phillips
Screw x 6



3/8" Flat Head Phillips
Screw x 4

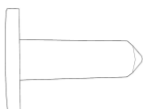

DD Rubber bumper x 6



EE Adjustable shelf clip x 4



FF 1" Flat head phillips screw x 10



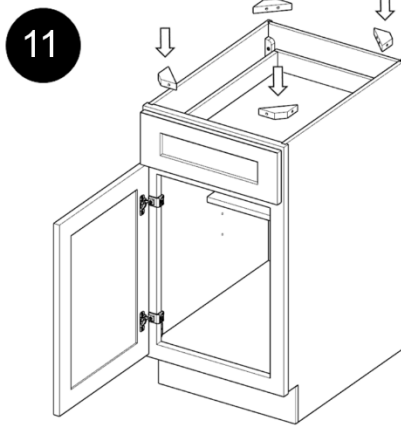
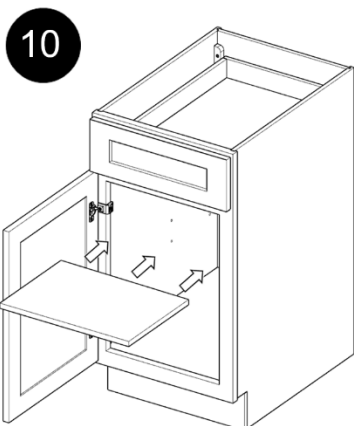
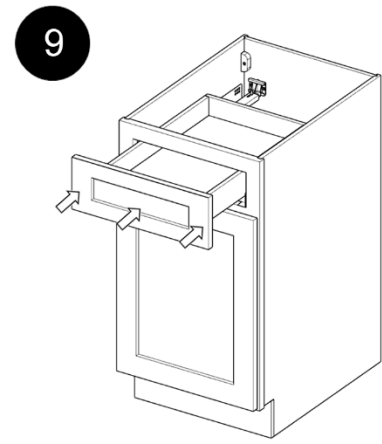
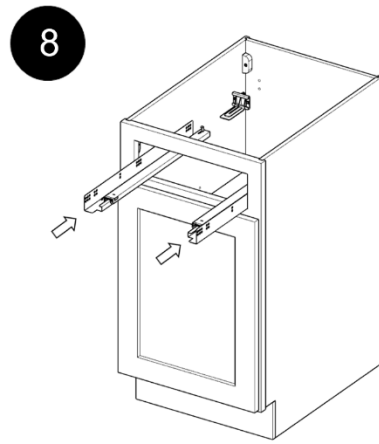
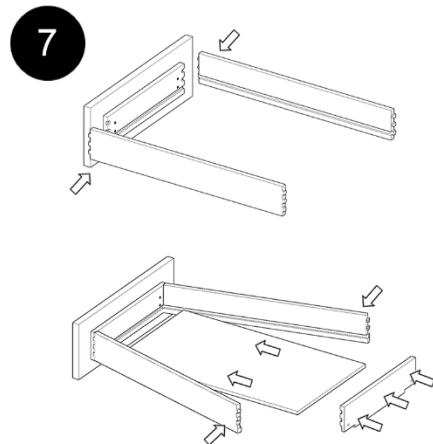
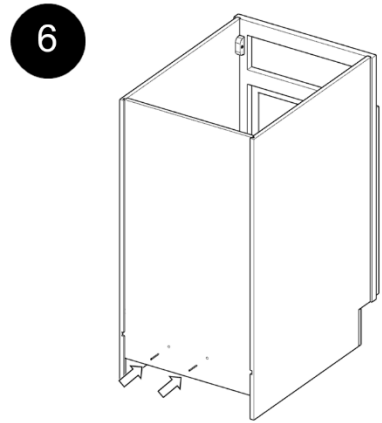
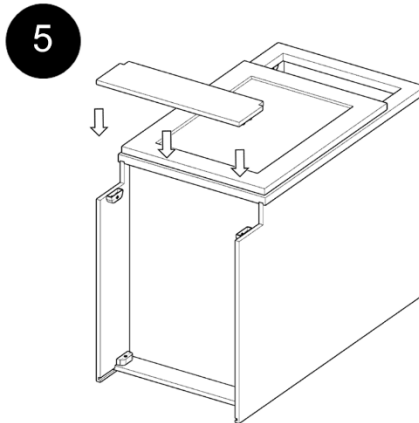
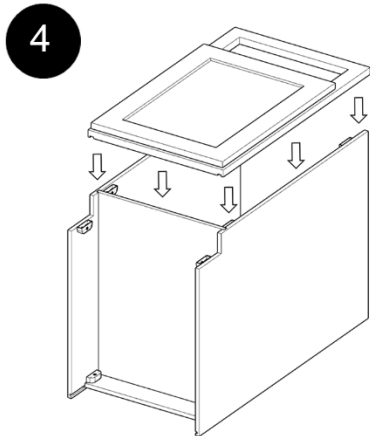
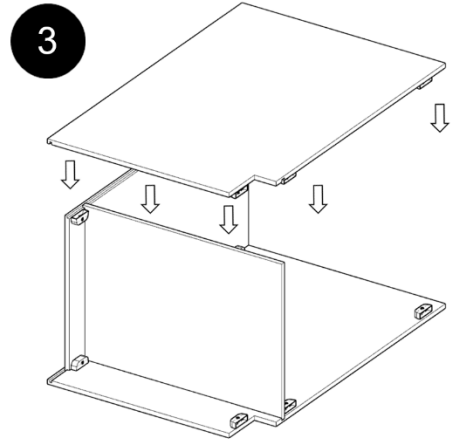
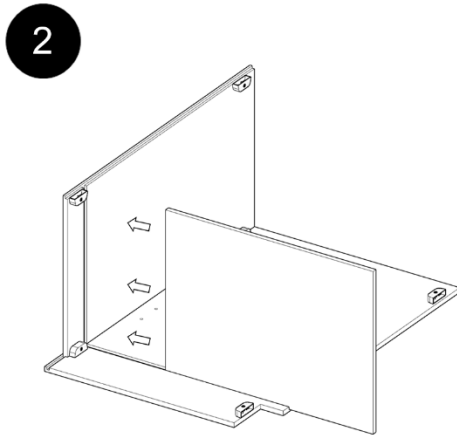
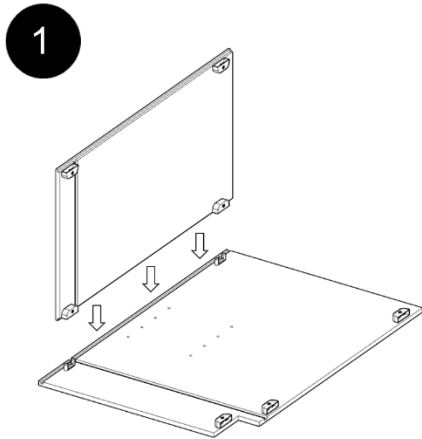

CAMLOCK CONNECTION

1. Insert the camlock to the locker.

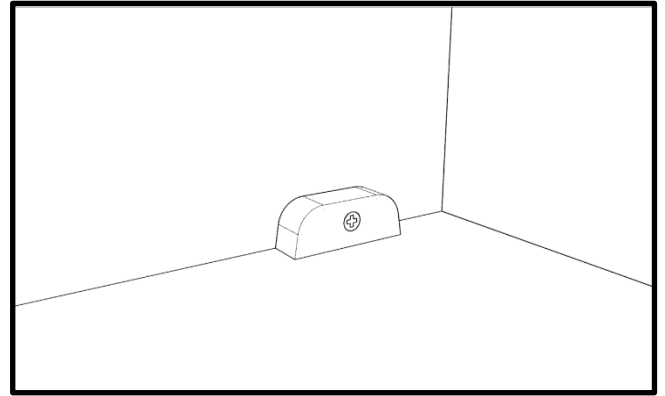
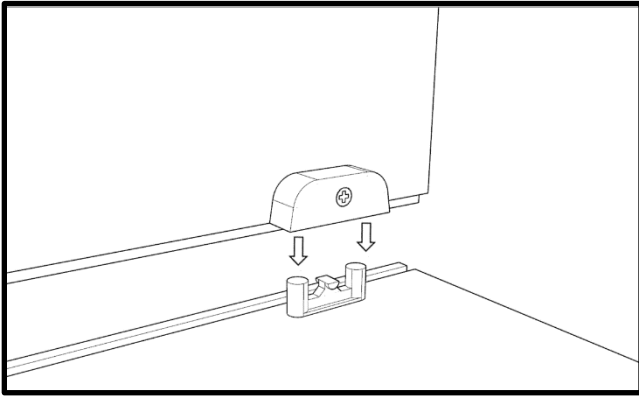

2. Turn the nut clockwise to latch two parts.

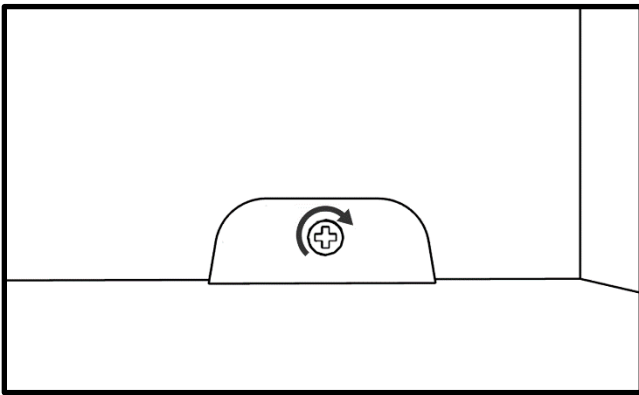

DRAWER CLIPS INSTALLATION

1. Drill two 5/8" flat head phillips screws with each drawer clips into drawer front panel

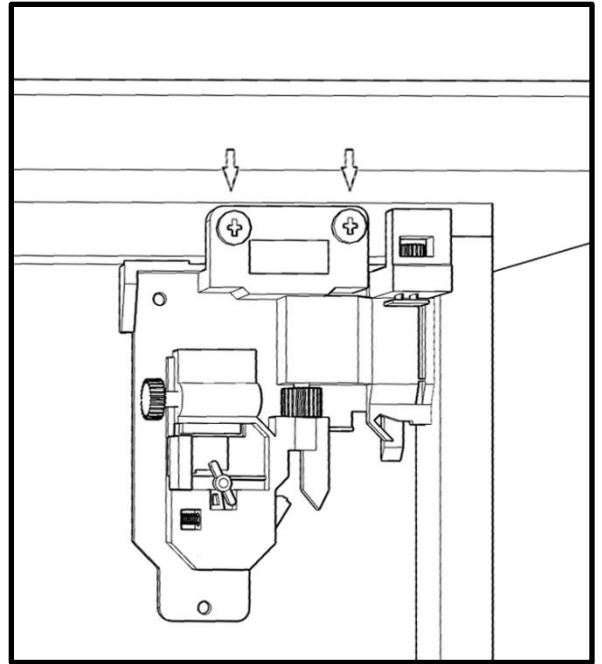
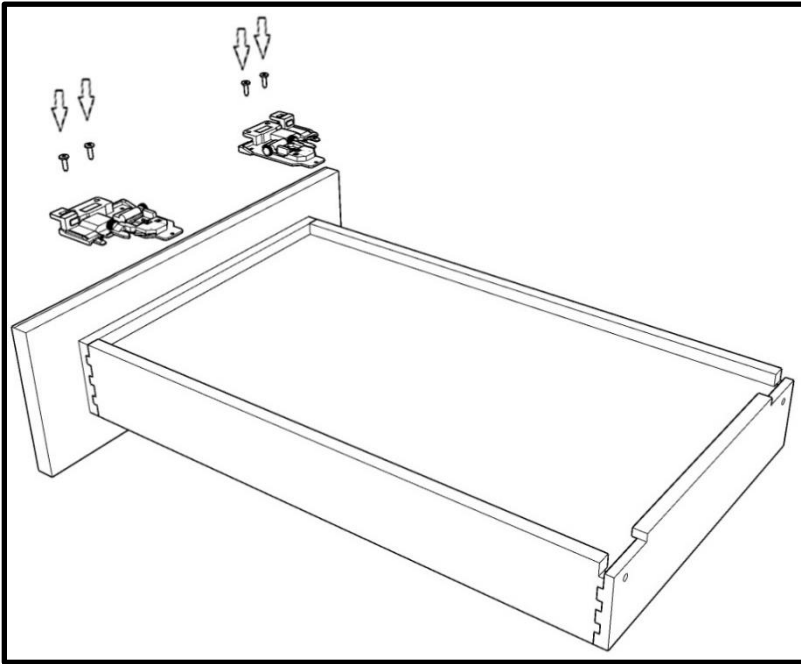

2. Drill two 3/8" flat head phillips screws to each drawer clips to drawer box bottom panel.

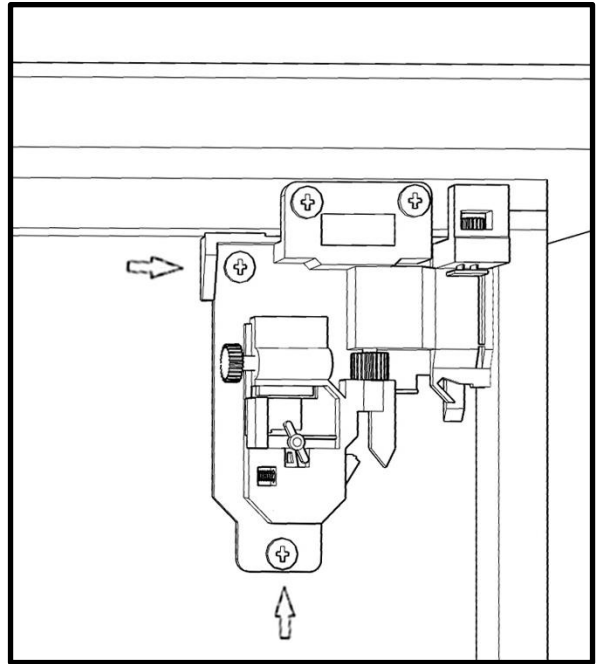
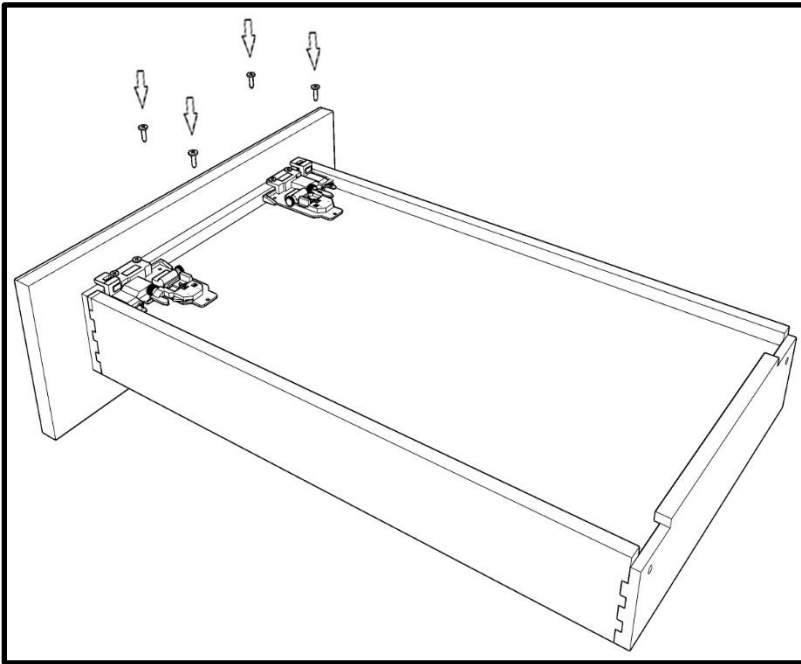

GLIDE AND RUNNER PROFILE INSTALLATION

1. Insert two glide bases into the pre-drilled holes on the cabinet box back panel, and drill two 5/8" flat head Phillips screws on each side to tighten two bases with the box back panel.

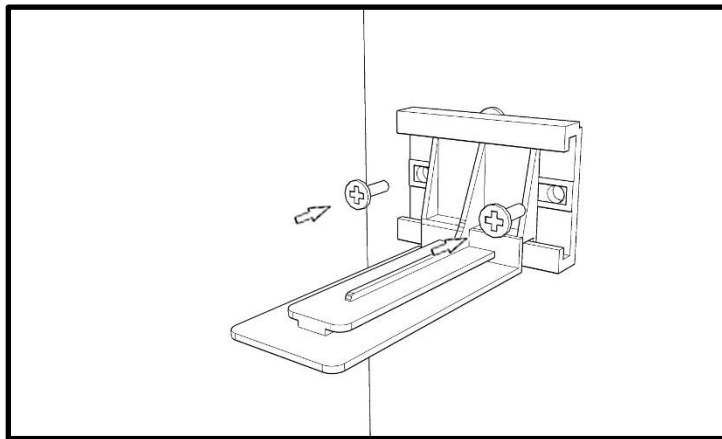
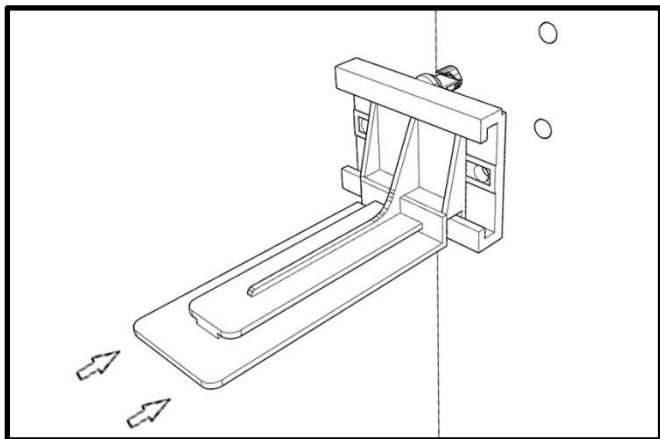

2. Connect glide and runner profiles with each glide base. Slightly pull out the glide to make the other side stay on the middle rail of the cabinet face frame.

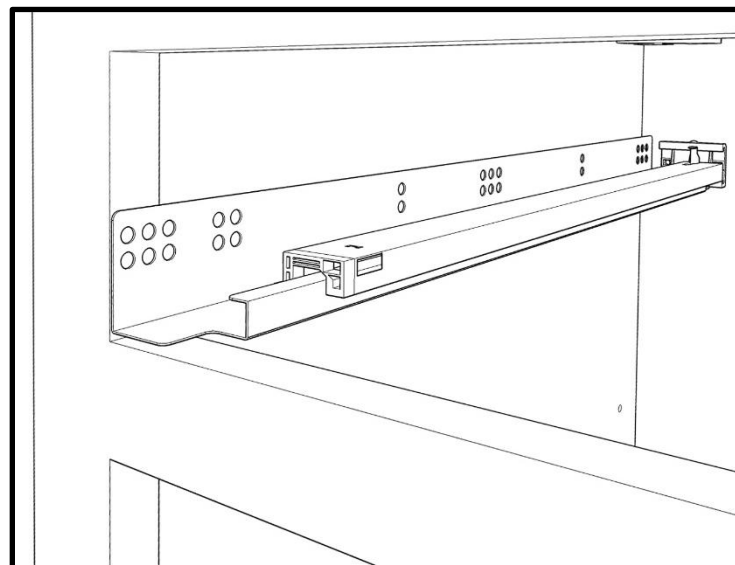
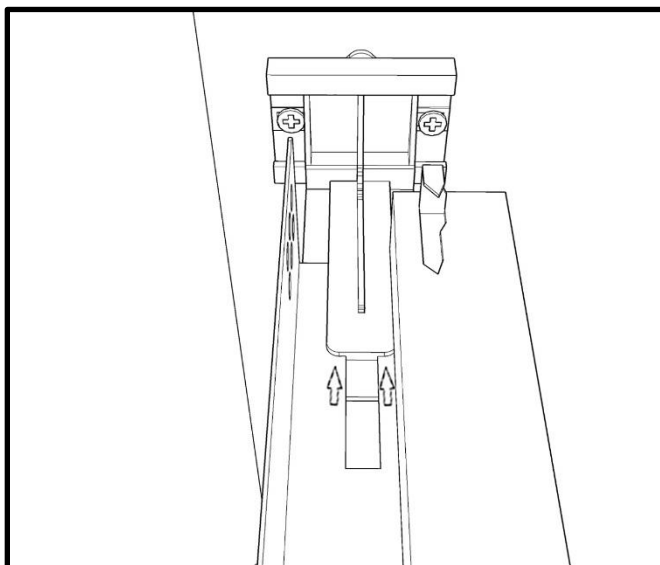

3. Drill two 5/8" flat head Phillips screws at each side to tighten glides and runner profiles to the cabinet face frame.

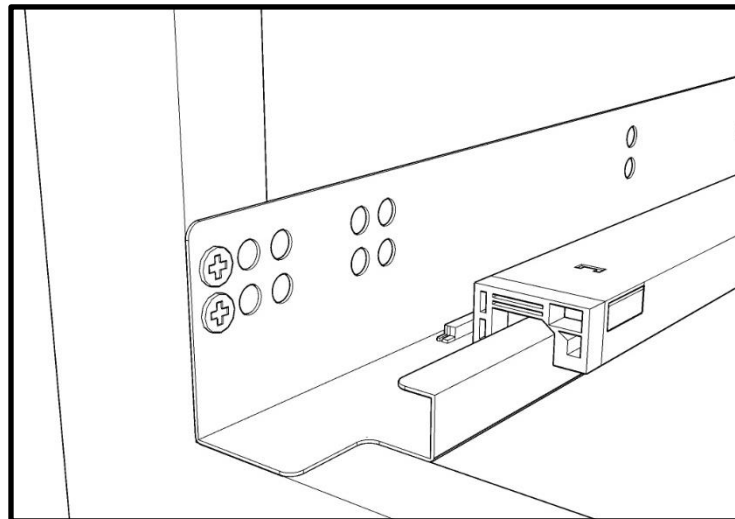
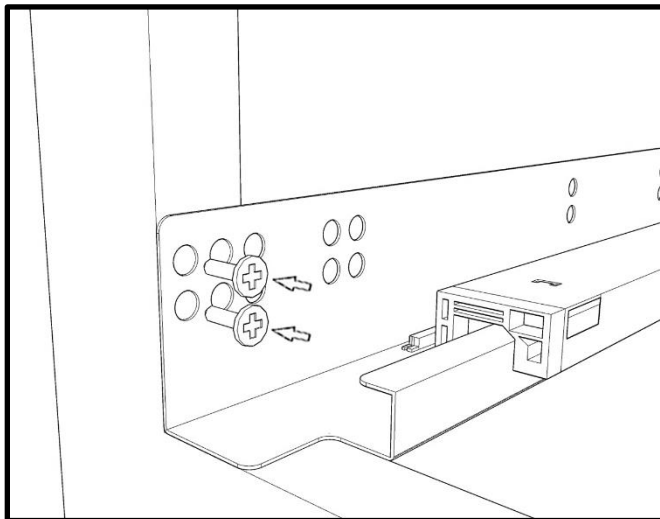

DRAWER ADJUSTABILITY GUIDE

1. Insert the drawer on the extended runner. To secure the drawer clips with the runner, push the drawer in. Upon successful locking, a click can be heard.

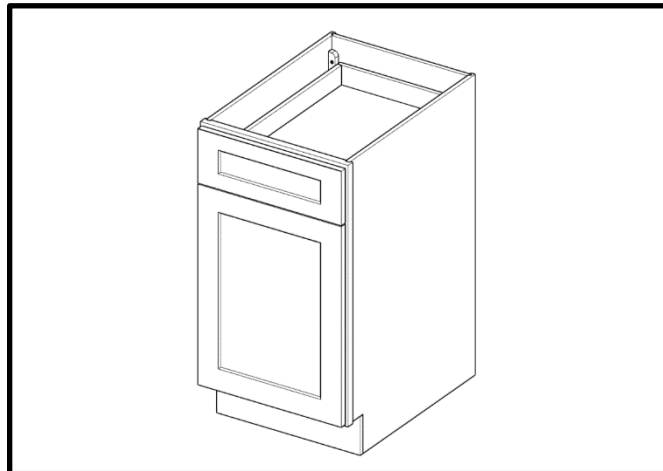
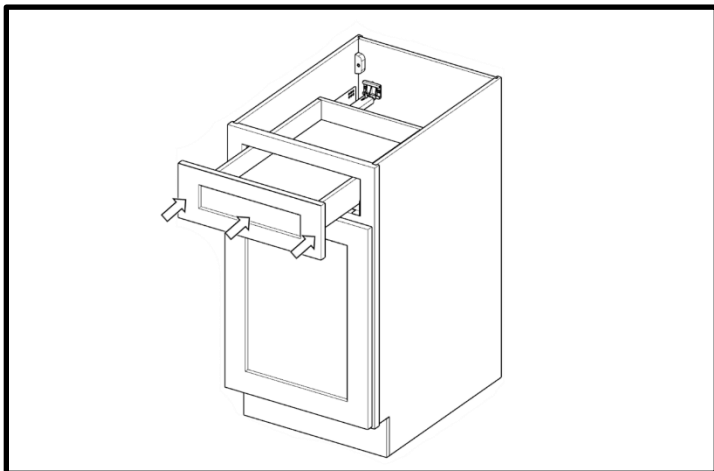

2. Insert the drawer on the extended runner. To secure the drawer clips with the runner, push the drawer in. Upon successful locking, a click can be heard. Ensure that the hook on each runner profile fits into the corresponding holes on the drawer back panel.

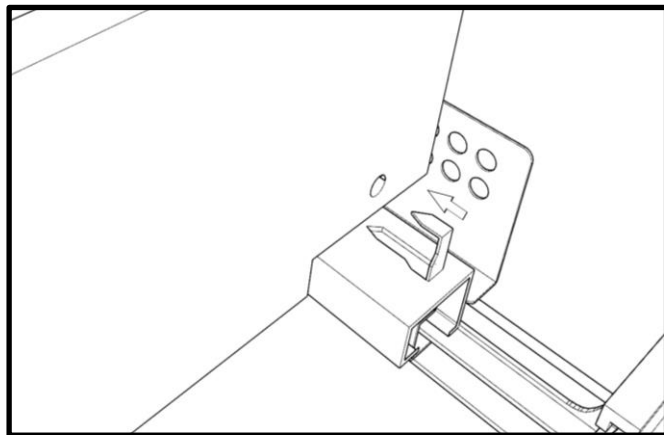
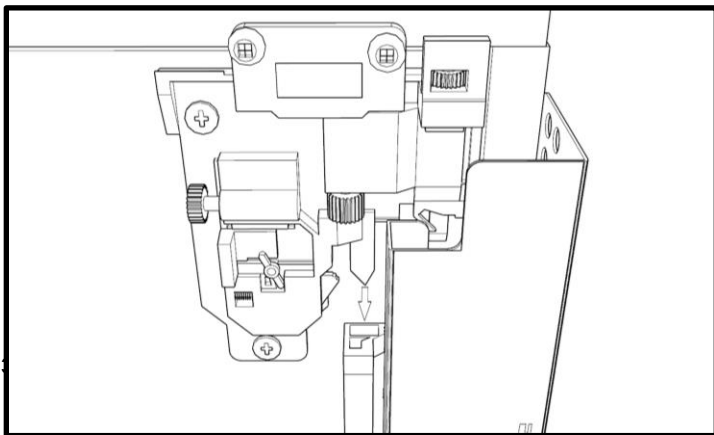

3a. To level the drawer, use the green spur gears on the side to adjust drawer left and right, the green spur gears on the middle to adjust drawer up and down, and the green spur gears on the top to adjust drawer inside and outside.

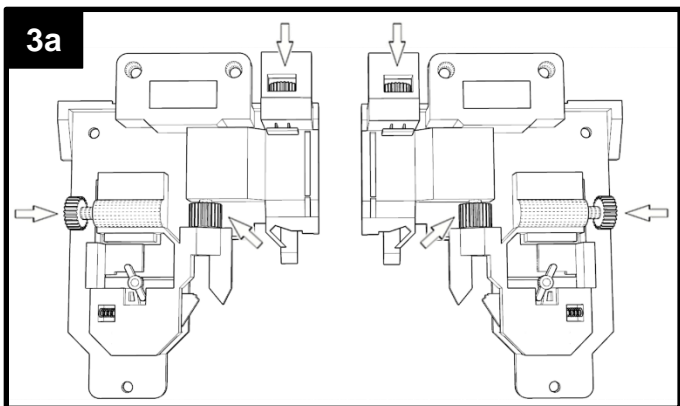

3b. To take the drawer out, push the green clips at the same time to unlock drawer clips.

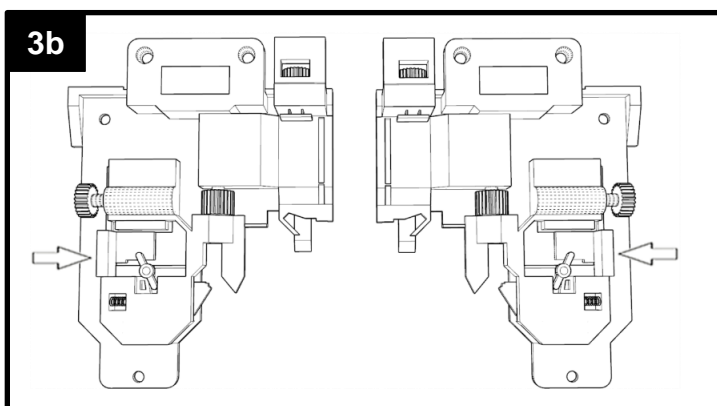

REVERSE DOOR INSTRUCTION

1. Undrill the 3/4" round head phillips screws from each hinge and take out the door panel.

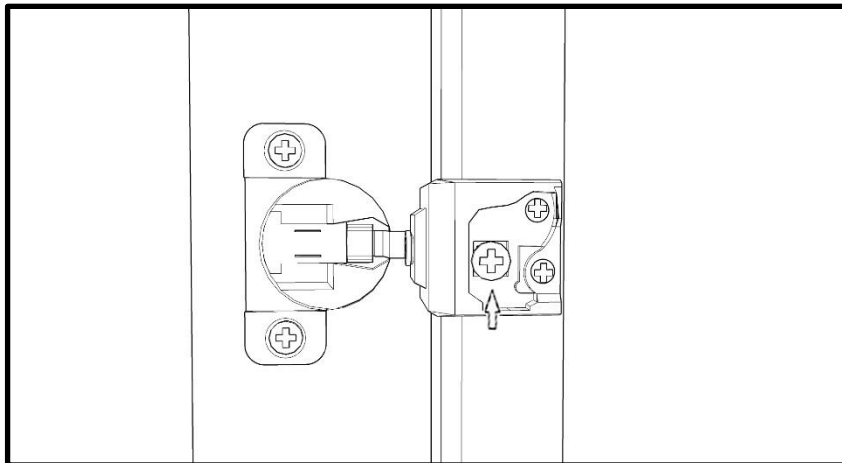
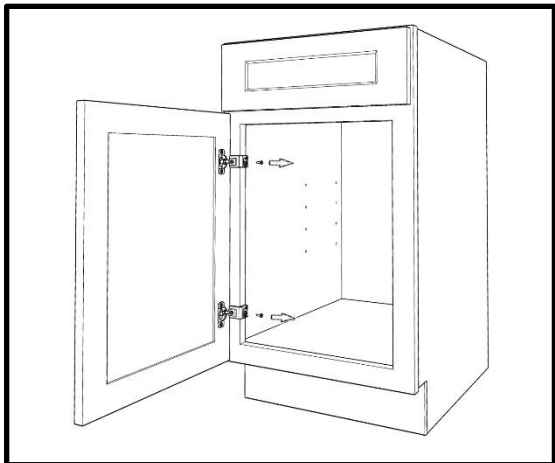

2. Reverse the door panel and drill the 3/4" round head phillips screws to each hinge through the pre-drilled holes to tighten the hinge with cabinet face frame.

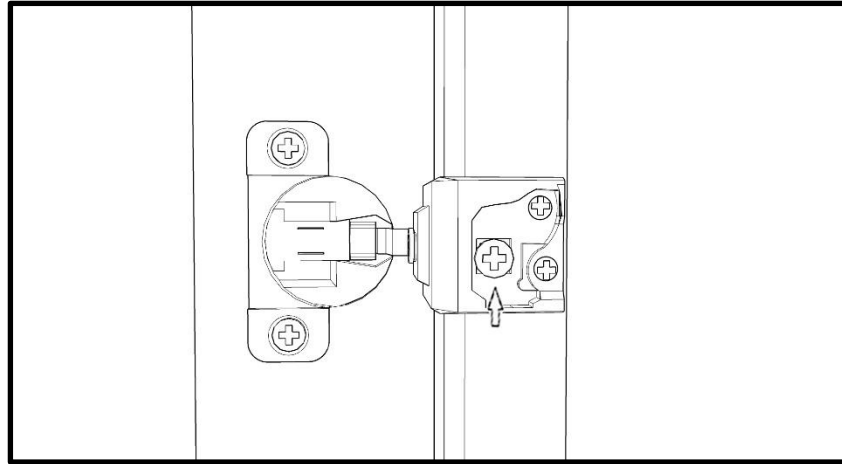
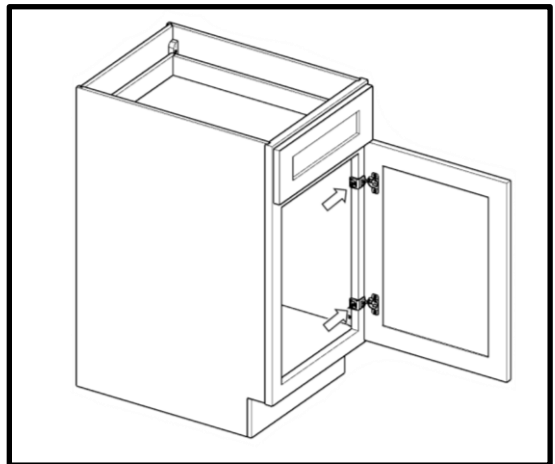

3. If the door is not level when it is installed, the customer will need to turn the screw clockwise to extend the hinge or counterclockwise to shorten the hinge.

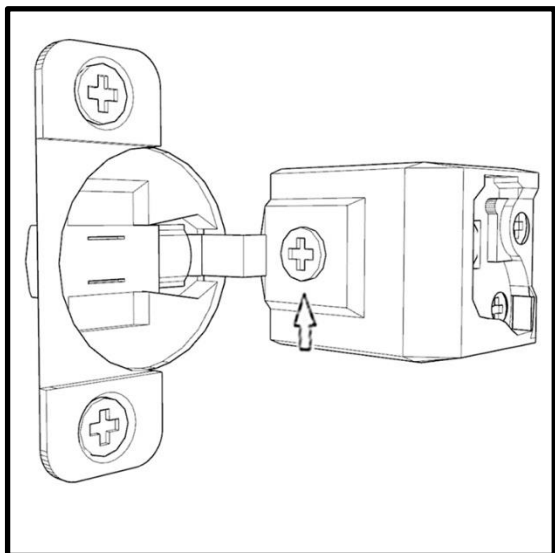

ADJUSTABLE SHELF INSTALLATION

1. Insert four shelf clips into the pre-drilled holes on the inner side of cabinet box side panels at the same height for one shelf.

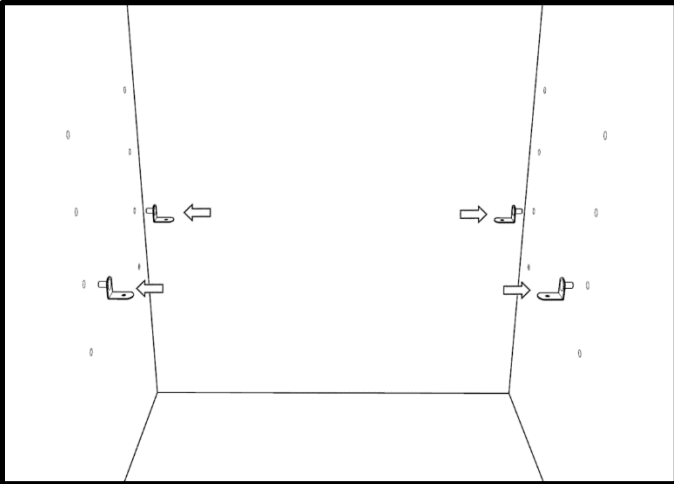

2. Insert the adjustable shelf at a tilted angle.

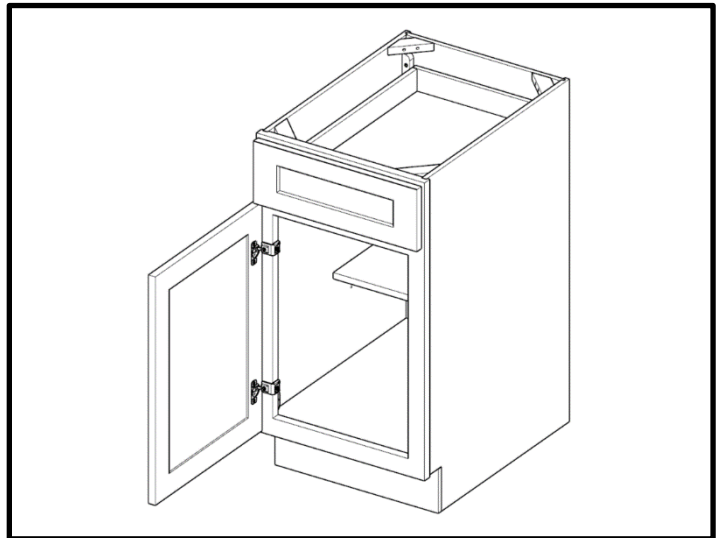
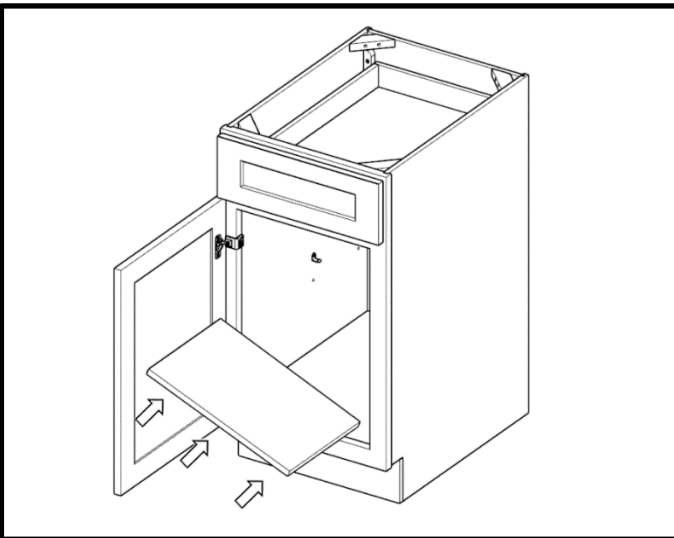

COUNTER CORNER BLOCK INSTALLATION

1. Place one counter corner block at the corner, align it with cabinet box panel. Hold it and use two 5/8" flat head Phillips screws to install the counter corner block. The use of a screwdriver is recommended.

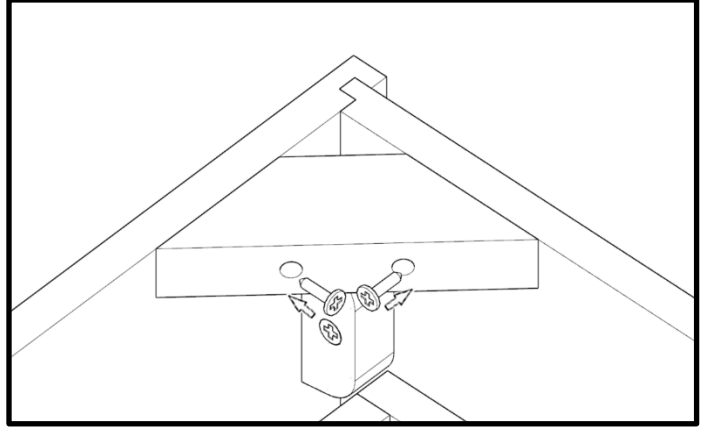
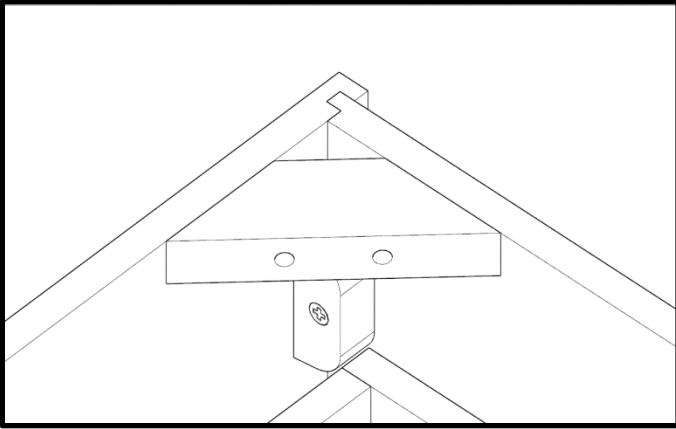

2. Install the other counter corner blocks in the same way.

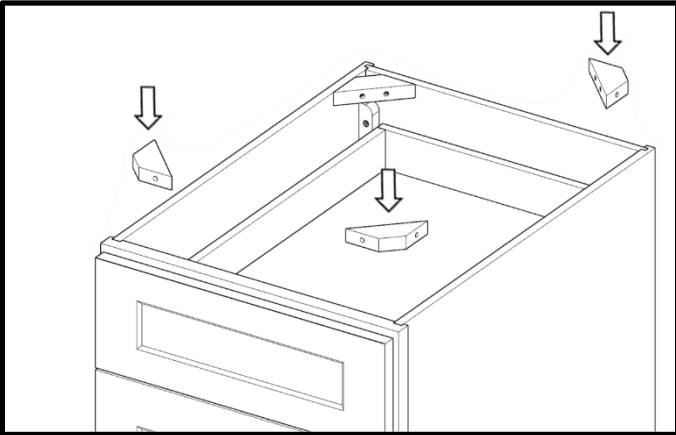

FASTEN BOX BOTTOM PANEL AND BOX BACK PANEL

1. Drill 1" flat head phillips screw to the predrilled holes and fasten box bottom panel with box back panel

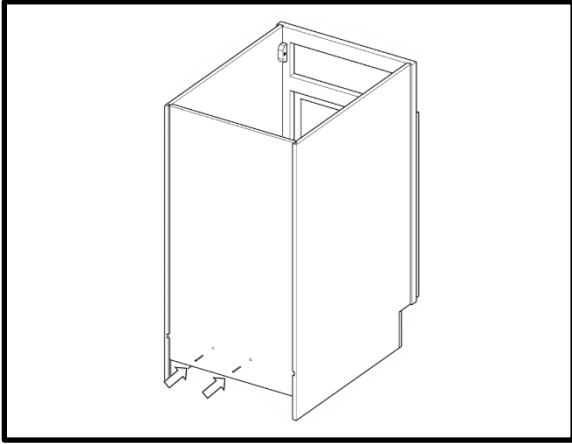

RUBBER BUMPER INSTALLATION

1. Attach rubber bumpers to 4 corners of each drawer face panel and 2 outsider corners of each door panel.

